



140930106772
BC130752-02
TRIM Record Number

1
DP 5452

WAIMAKARIRI DISTRICT COUNCIL
Plans and specifications APPROVED in accordance
with the Building Act 2004, clause 49 and the Building
Regulations 1992, Clause 3
130752 7/05/2013 nicolah

Note:
The areas shown hatched hereon and labelled A & B are to be subject to a 'no dwelling' covenant.

a water mains and lines
dotted from council records

BARKERS

The information for this plot has been taken from Waimakariri District Council records. Every reasonable effort has been made to ensure that the information is correct and accurate information on this map. The information contained herein has been assembled in good faith, but its accuracy and completeness cannot be guaranteed.

Copyright 2012

BC130752

ISSUED CONSENT BC130752

BARKERS ROAD

0 m



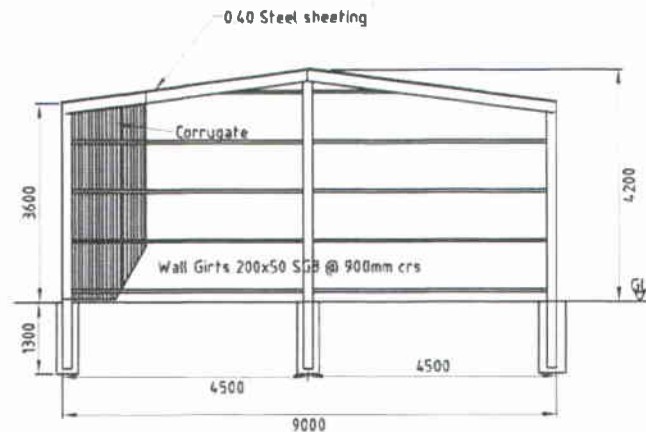

End Elevation

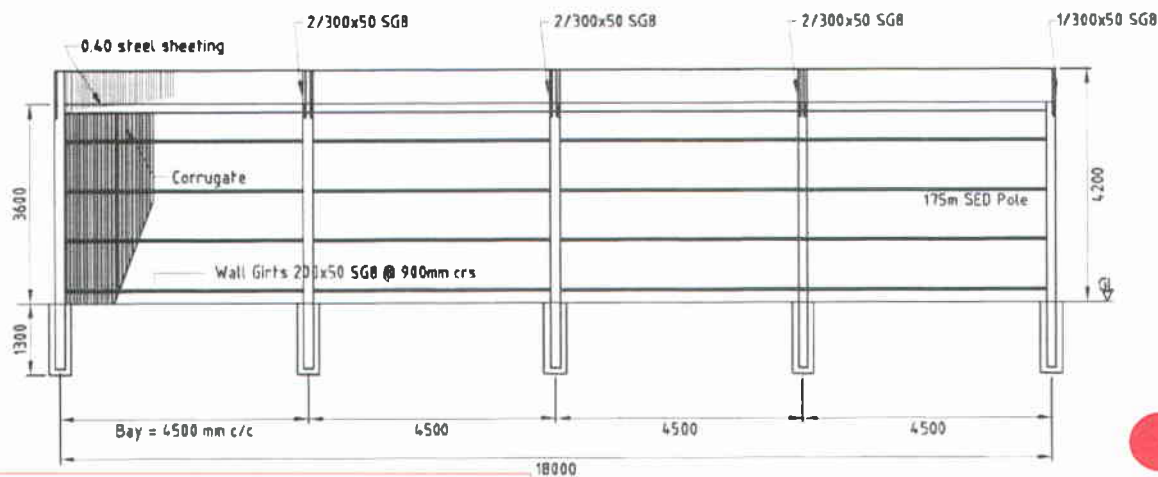

Rear Elevation

Pryda Strapbrace
Tensioned after 6 nails ea. end
Then 2 nails ea. purlin/Rafter
crossing

All poles to be min $\phi 175\text{mm}$ SED Pole

All timber H3 2 treated except
pole to be H5 treated

200x50 SG8
Purlins @ 900 c/c

Plan

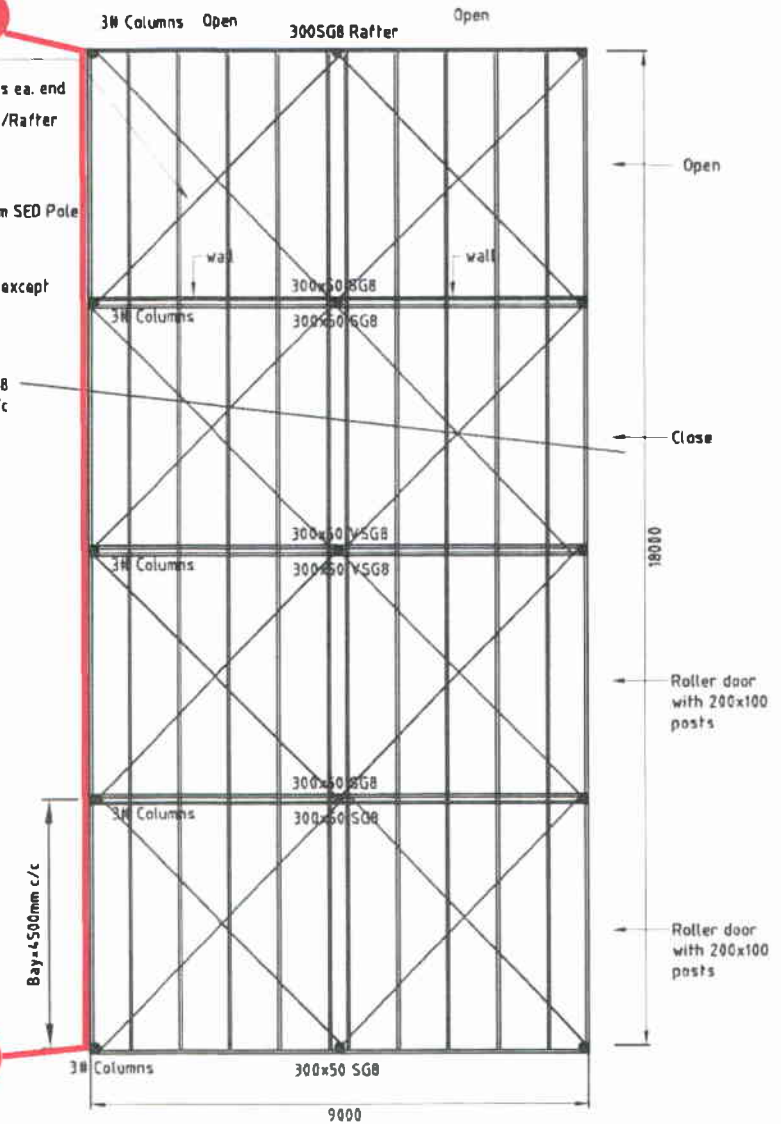

120mm diameter spouting with 80mm diameter downpipe to soakpits via 100mm diameter drain at 1:120min gradient

WAIMAKARIRI DISTRICT COUNCIL
Plans and specifications APPROVED in accordance
with the Building Act 2004, clause 49 and the Building
Regulations 1992, Clause 3
130752 7/05/2013 nicolah

McAlpines

Job Name:	Issue:	Status:	Designed for:	Project Number:	Dwg:
				18860	1
			Designed by:	Drawn by:	Checked by:
			YL/AvB	YL	AvB
			Date:	Scale:	
			19/04/2013	Not scale	

Pryda Solutions: 38 Canaveral Drive, Albany, Auckland Ph.(09) 477 2965 Fax (09) 477 3518 e-mail: tin@pryda.co.nz

pryda®

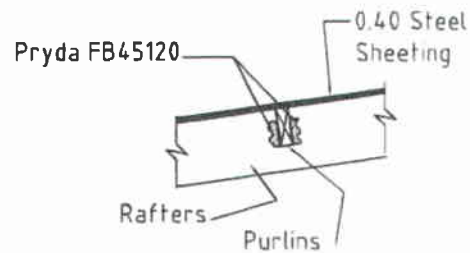

C Purlin to Rafter Detail
Scale 1:25

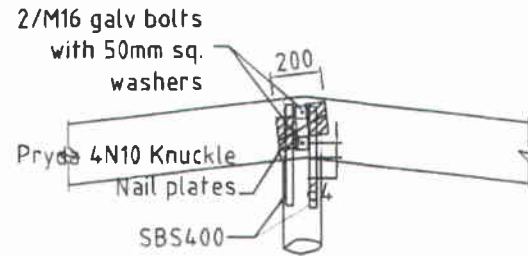

E Rafter Splice Detail

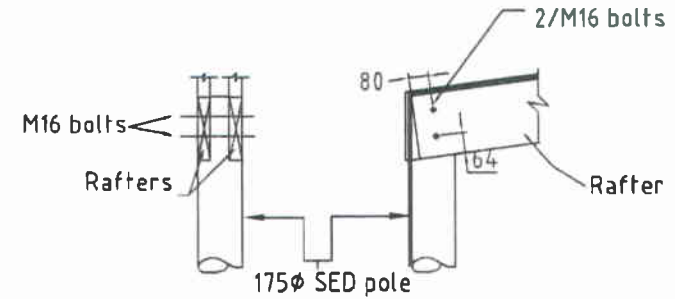

B Rafter to Pole Detail

WAIMAKARIRI DISTRICT COUNCIL
Plans and specifications APPROVED in accordance
with the Building Act 2004, clause 49 and the Building
Regulations 1992, Clause 3
130752 7/05/2013 nicolah

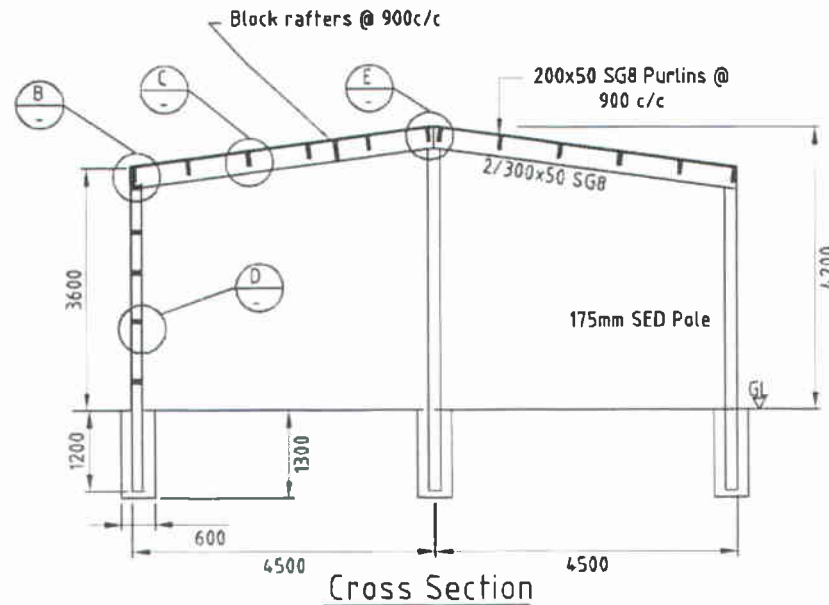

Cross Section

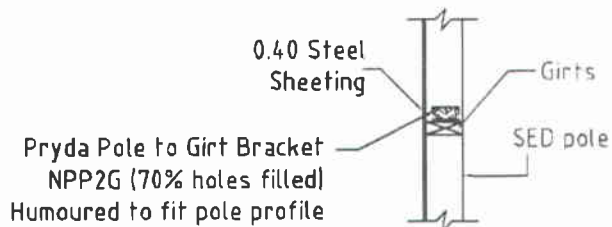

D Girt to Pole Detail

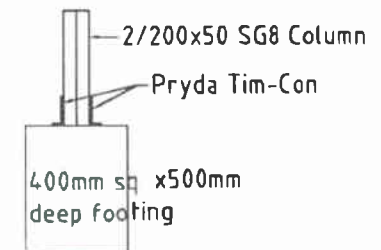

F Column Foot Detail

McAlpines

Job Name:	Issue:	Status:	Designed for:	Project Number:	Dwg:
				18860	2
			Designed by:	Drawn by:	Checked by:
			YL/AvB	YL	AvB
			Date:	19/04/2013	Scale:
					Not Scale

Pryda Solutions; 38 Canaveral Drive, Albany, Auckland Ph.(09) 477 2965 Fax (09) 477 3518 e-mail: lin@pryda.co.nz

pryda



McAlpines Building Division
McAlpines Timber Limited
PO Box
Rangiora 7440

WAIMAKARIRI DISTRICT COUNCIL
Plans and specifications APPROVED in accordance
with the Building Act 2004, clause 49 and the Building
Regulations 1992, Clause 3
130752 7/05/2013 nicolah

Re: Shed Cladding and Flashing detail

Client: R & L Giller
Site Address: 424 Barkers Road, Loburn.

Selected Cladding: Corrugated Coloursteel 0.4mm.

Minimum Roof overhang: 75mm.

Cladding Fixings: 12-14g x 65mm Type 17, roof screws with Neoprene seal. Install at approximately 5 units per lineal metre.

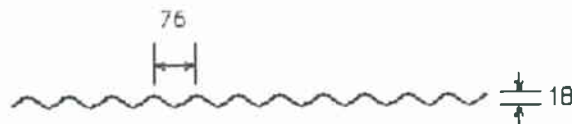

Wall Flashing: Wrap Design (Typical)

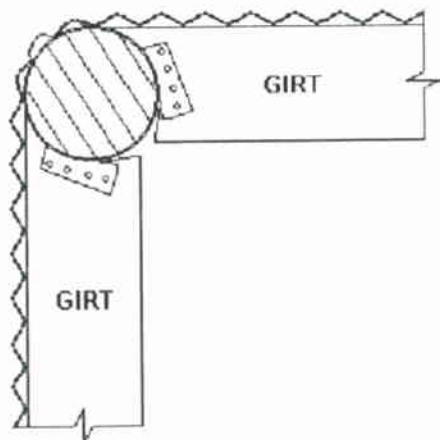

WALL CROSS SECTION

Roof Barging: Flashing Design

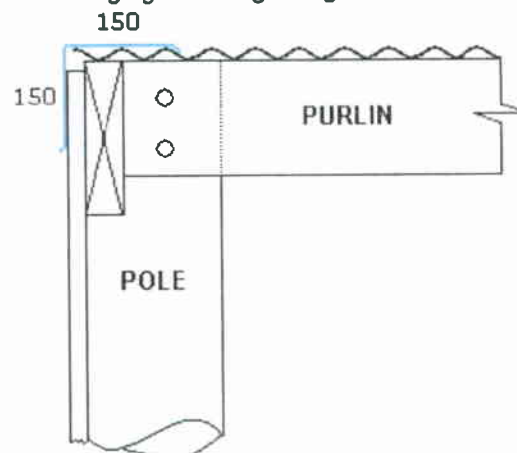

ROOF CROSS SECTION

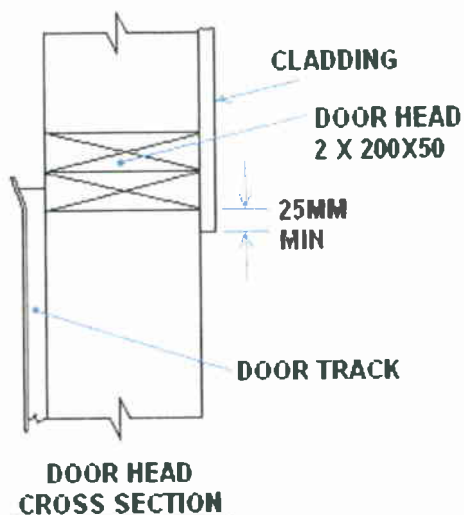

**DOOR HEAD
CROSS SECTION**

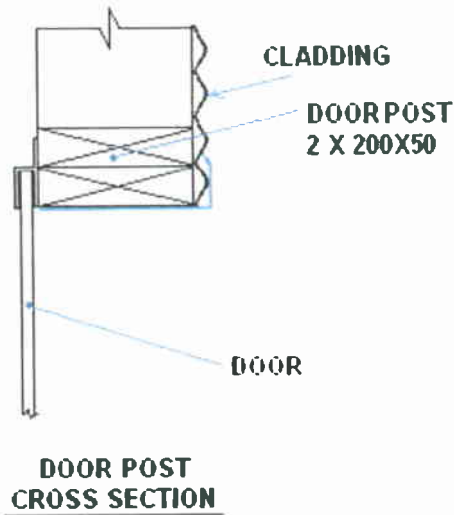

**DOOR POST
CROSS SECTION**

ALL DOOR FRAMING 200X50 TREATED H3.2 RS RADIATA



McAlPines Building Division
McAlPines Timber Limited
PO Box
Rangiora 7440

WAIMAKARIRI DISTRICT COUNCIL
Plans and specifications APPROVED in accordance
with the Building Act 2004, clause 49 and the Building
Regulations 1992, Clause 3
130752 7/05/2013 nicolah

Re: Shed - Rainwater Gutter & Down pipe detail

Client: R & L Giller
Site Address: 424 Barkers Road, Loburn

Gutter: Rainwater Systems, Freeline Classic. Coloursteel 0.4mm.

Minimum Roof overhang into gutter: 75mm.

Down pipe: Diameter 80mm. Zincalume or Coloursteel 0.4mm.



SOAKHOLE SPECIFICATIONS

All soakholes 500 mm to 1 m into soakage material - where possible check by pouring 40 litres of water into hole.

Soil type	No of Dps	Soakhole base size	Cubic metres of material ie: 20-40s or boulders
1. Free draining river type shingles	1	500mm x 1m = .5 square m	1 cubic metre minimum
	2	500mm x 1.5m = .75 sq m	1.5 cubic metres minimum
	3	500mm x 2m = 1 sq metre	2 cubic metres minimum
2. Free draining river type shingles and silt	1	500mm x 2m = 1 square m	2 cubic metres minimum
	2	500mm x 2.5m = 1.25 sq m	2.5 cubic metres minimum
	3	500mm x 3m = 1.5 sq metres	3 cubic metres minimum
3. Silty soil/ shingle into ground water	1	1 m x 2 m = 1 square metre	3 cubic metres minimum
	2	1 m x 2.5 m = 2.5 sq metres	3.5 cubic metres minimum
	3	1 m x 3 m = 3 sq metres	4 cubic metres minimum

WAIMAKARIRI DISTRICT COUNCIL
Plans and specifications APPROVED in accordance
with the Building Act 2004, clause 49 and the Building
Regulations 1992, Clause 3
130752 7/05/2013 nicolah

Figure 13: Soak Pit for Surface Water Disposal
Paragraph 9.0.4

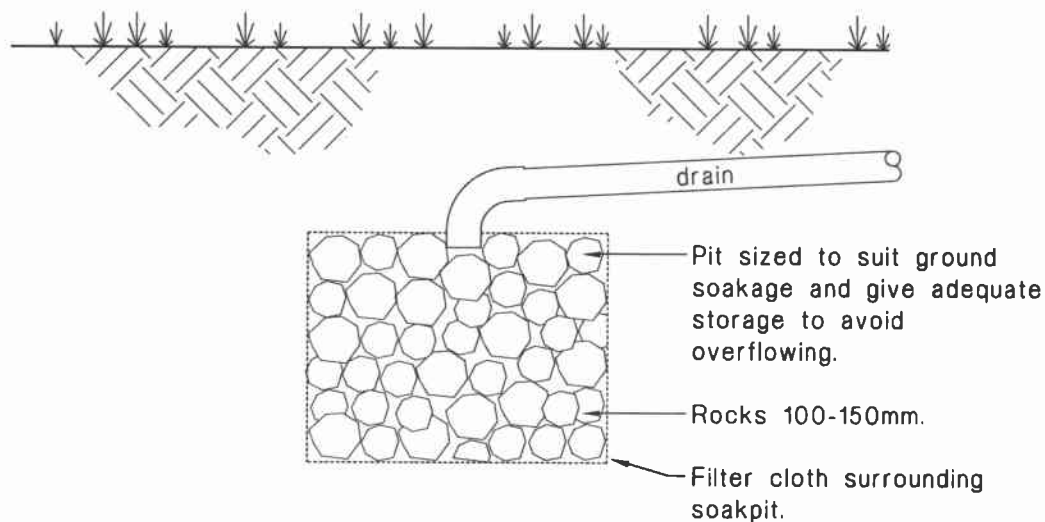

(a) Rock soak pit

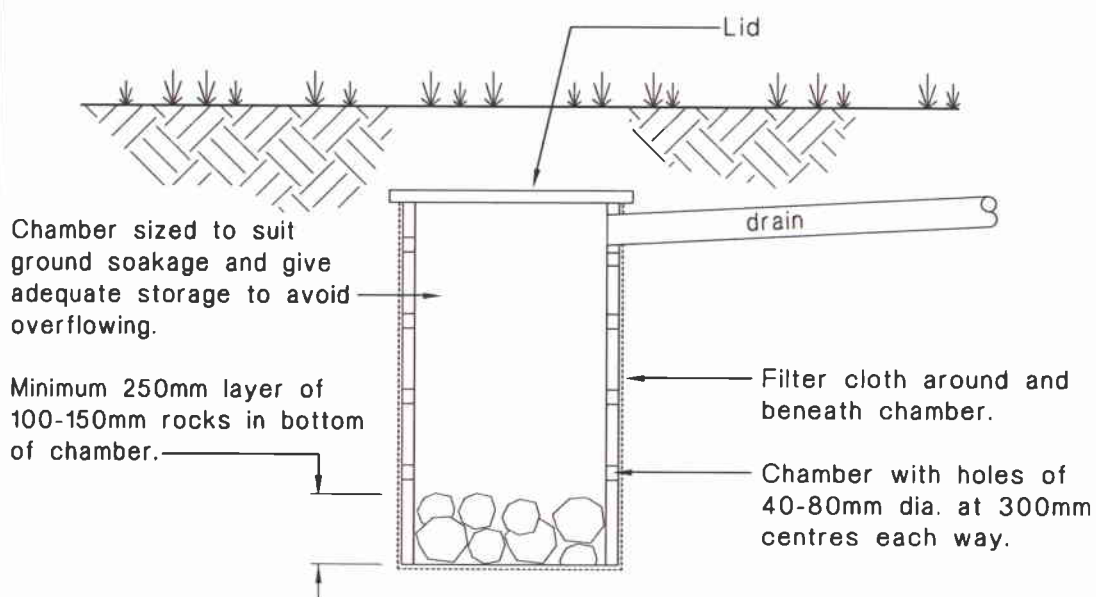

(b) Chamber soak pit

WAIMAKARIRI DISTRICT COUNCIL
Plans and specifications APPROVED in accordance
with the Building Act 2004, clause 49 and the Building
Regulations 1992, Clause 3
130752 7/05/2013 nicolah